

LOC	DIST	P	F	ZONE	LTR	DESCRIPTION	DATE	APPD
AJ	16					0 REL PER 93-3361-003	01/28/93	JPD
						A REV PER 0130-0190-93	12/APR/93	JPD

- 1. BRASS PER QQ-B-626.
- 2. PTFE PER MIL-P-19468.
- 3. PHOSPHOR BRONZE PER QQ-B-750.
- 4. BERYLLIUM COPPER PER QQ-C-530.
- 5. TIN LEAD PLATE PER ASTM-B-545.
- 6. COPPER PLATE PER MIL-C-14550.
- 7. NICKEL PLATE PER QQ-N-290.
- 8. GOLD PLATE PER MIL-G-45204.
- 9. DIELECTRIC AND CONTACT ASSEMBLY WILL WITHSTAND 2.5 LB PUSHOUT FORCE DIRECTED FROM MATING END.

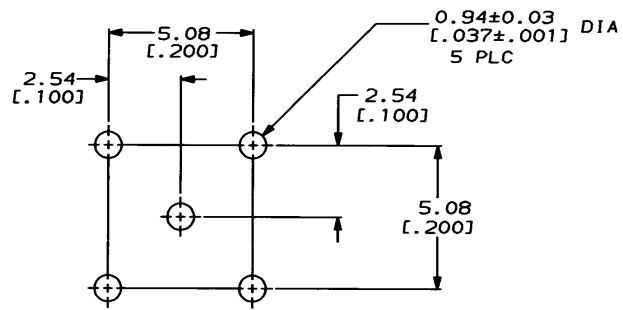
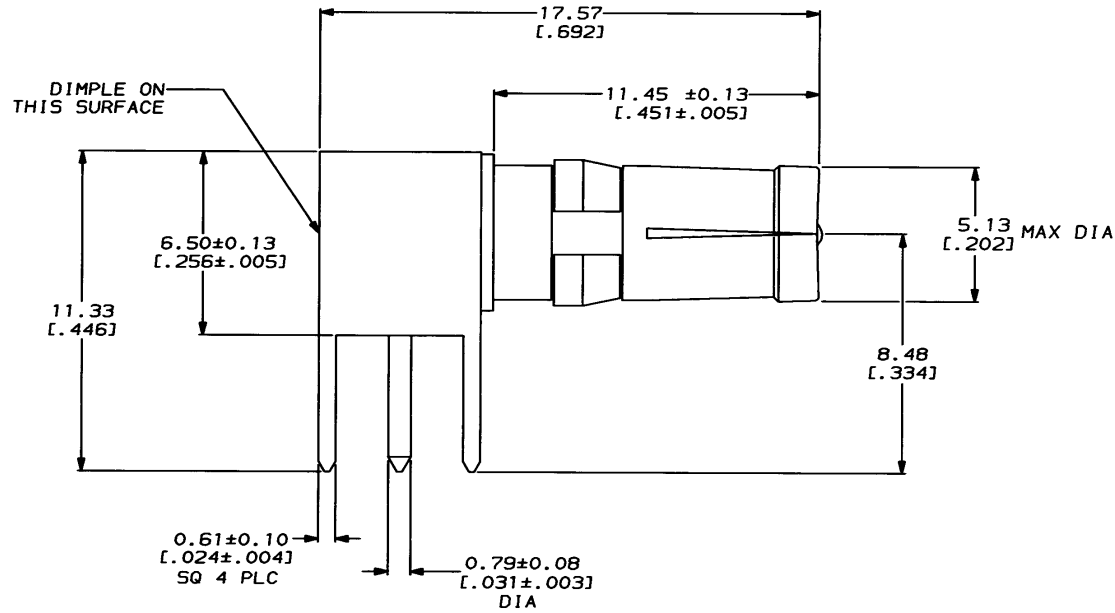

PCB CONFIGURATION

DO NOT SCALE PRINT. UNLESS SPECIFIED DIMENSIONS IN INCHES TOLERANCES ON:		DR 01/29/93 J.DAVIS		414507-1 PART NO	
2 PLC DEC ± .010		CHK 08-29-91 01/29/93		AMP AMP Incorporated Harrisburg, PA 17105-3608	
3 PLC DEC ± .010		APPD 01/29/93 G.MICHAEL		NAME	
ANGLES ± 0°30'		APPD 01/29/93 J.DAVIS		SOCKET, PCB, RIGHT ANGLE	
MATERIAL		PRODUCT SPEC		SIZE 8, HDI	
FINISH		APPLICATION SPEC		SIZE C	CAGE CODE 00779
1 2 3 4		WEIGHT -		DRAWING NO 414507	
5 6 7 8				SCALE 8:1	SHEET 1 OF 1

CUSTOMER DRAWING