

SUGGESTED PANEL CUTOUT

MATERIALS

**BODY:**  
Polyamide 6/6 (PA66), UL94 V-2

**ACTUATOR:**  
Polyamide 6/6 (PA66), UL94 V-2

**SEALING MEMBRANE:**  
Polyvinyl Chloride (PVC)

**SPRING:**  
Phono wire

**MOBILE CONTACT BAR:**  
Copper

**CONTACT PADS:**  
Silver Clad Copper

**RIFETS:**  
Copper

**TERMINALS:**  
Brass

SPECIFICATIONS

**FUNCTION:**  
2PT OFF-(ON)

**RATINGS:**  
ANSI/UL 508 and CAN/CSA C22.2 No.14 (E198908):  
15A 277VAC [cULrus]  
15A 277VAC [cULrus]  
15HP 110/250VAC [cULrus]

**CONTACT RESISTANCE:**  
Initial: 10mΩ Max.  
Electrical Life: [cULrus]  
6,000 Cycles [cULrus]

**TEMPERATURE:**  
Operating: 0°C to 40°C [cULrus]

**INGRESS PROTECTION:**  
IP54

**APPROVALS:**  
cULus  
RoHS COMPLIANT

COLORS AND MARKINGS

**BODY COLOR:**  
Black

**ACTUATOR COLOR:**  
Black

**MARKING:**  
None

**MARKING COLOR:**  
None

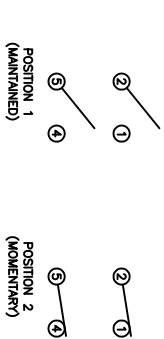
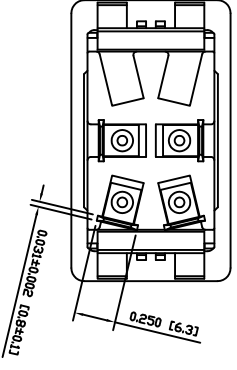

SCHEMATIC

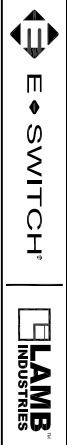

RW4ED1100

ACTUATOR	B	10/09/28	CAB
BODY	B	10/09/28	CAB
COLORS	A	09/06/15	CAB
MATERIALS	C	10/03/01	CAB
SPECIFICATIONS	C	10/03/01	CAB
REFERENCE	REV.	DATE	BY

THE INFORMATION CONTAINED IN THIS DOCUMENT IS PROPRIETARY TO E-SWITCH AND IS NOT TO BE COPIED OR TRANSMITTED

CONNECTED SPECIFICATION ON HP, www.3HP	21287	02/18/13	cc
CONNECTED SPECIFICATIONS	PO80247	09/12/09	CAB
INITIAL RELEASE	PO80251	09/08/05	CAB
DESCRIPTION	PCR	DATE	DRAWN BY

DIMENSIONS	
INCHES [MILLIMETERS]	
GENERAL TOLERANCES	±0.008 [±0.2] / ±1°
SCALE	DRAWING NOT TO SCALE
PROJECTION	

DRAWING NUMBER	34-RW4ED1100	DATE	DECEMBER 9, 2009	REVISION	C
----------------	--------------	------	------------------	----------	---